

prima

Undercounter Wine Cooler Instruction Manual

PRWC401

PRWC402

PRWC403

PRWC404

INTRODUCTION

Thank you for buying your new Wine Cooler.

To ensure that you get the best results from your new purchase, we strongly suggest that you read this instruction manual thoroughly before use. This manual contains installation advice, usage instructions and other important facts about your Cooler. If treated with care your Wine Cooler will give you many years of trouble free use.

WARNINGS

- To prevent damaging the door gasket, make sure the door is fully open when pulling shelves out of the rail compartment.
- The appliance must be positioned so that the plug is accessible. Release the electric cord and move your Cooler to its final location. Do not move your wine cooler while loaded with wine as you may distort the body.
- The wine cooler should be installed in a suitable place in order to avoid touching the compressor.
- After unpacking, make sure that the appliance is in perfect order. If you have any doubt, do not use it and contact your retailer.
- If the supply cord is damaged, it must be replaced by a service agent or a similarly qualified person in order to avoid a hazard.
- This product is not designed for commercial use, it is a household appliance only.

It is not intended to be used in:

- Staff kitchen areas in shops, offices and other working environments
- Bed and breakfast type environments
- By clients in hotels, motels and any other residential type environments

-
- This appliance is intended to be used exclusively for the storage of wine.

ELECTRICAL SHOCK HAZARD

To reduce the risk of fire, electrical shock, or injury when using your appliance, follow these basic precautions:

- Read all instructions before using the wine cooler.
- **DANGER or WARNING:** Risk of child entrapment.
- Before you throw away your old wine cooler: Take off the door, leaving the shelves in place so that children cannot easily climb inside.
- Never allow children to operate, play with, or crawl inside the appliance.
- Never clean appliance parts with flammable fluids. The fumes can create a fire hazard or explosion.
- Do not store or use gasoline or any other flammable vapours and liquids in the vicinity of this or any other appliance. The fumes can create a fire hazard or explosion.

- The refrigerant of this appliance is R600a, flammable and explosive articles should not be put in or near the cabinet, to avoid the risk of fire or explosion.
- This appliance can be used by children aged from 8 years and above and persons with reduced physical, sensory or mental capabilities or lack of experience and knowledge if they have been given supervision or instruction concerning use of the appliance in a safe way and understand the hazards involved. Children shall not play with the appliance.
- Cleaning and user maintenance shall not be made by children without supervision.
- When positioning the appliance, ensure the supply cord is not trapped or damaged.
- Do not locate multiple portable socket-outlets or portable power supplies at the rear of the appliance.
- Do not use plug adapter.



Symbol ISO 7010 W021

Warning; Risk of fire / flammable materials

ENVIRONMENTAL PROTECTION



Waste electrical products should not be disposed of with household waste. Please recycle where facilities exist. Check with your Local Authority or retailer for recycling advice. This appliance is marked according to the European directive on Waste Electrical and Electronic Equipment (WEEE).

By ensuring this product is disposed of correctly, you will help prevent potential negative consequences for the environment and human health, which could otherwise be caused by inappropriate waste handling of this product. The symbol on the product indicates that this product may not be treated as household waste. Instead it shall be handed over to the applicable collection point for the recycling of electrical and electronic equipment. Disposal must be carried out in accordance with local environmental regulations for waste disposal.

For more detailed information about treatment, recovery and recycling of this product, please contact your local council, your household waste disposal service or the retailer where you purchased the product

CE DECLARATIONS OF CONFORMITY **CE**

This appliance has been manufactured to the strictest standards and complies with all applicable legislation, Low Voltage Directive (LVD) and Electromagnetic Compatibility (EMC).

INSTALLATION

Before using your wine cooler

- Remove the exterior and interior packing.
- **IMPORTANT:** Before connecting the wine cooler to the power source, let it stand upright for at least 12 hours. This will reduce the possibility of a malfunction in the cooling system from handling during transportation.
- Clean the interior surface with lukewarm water using a soft cloth. Before installation, turn the unit off and unplug it from the outlet.

NOTE

To protect the appliance in transit and delivery the door is packed tightly against the cabinet. When first installed this can mean the door seal appears thinner on one side of the door due to compression, this is normal and once out of the box it will relax over a short period of time and the door will return to the normal position. If you wish to speed up the process you can gently warm the seal with a hair dryer on a low temperature setting. This can help relax the seal helping it return to normal thickness a little faster.

WARNING: INCORRECT EARTHING CAN RESULT IN THE RISK OF ELECTRIC SHOCK

Attention!

- Store wine in sealed bottles
- Do not overload the cabinet
- Do not open the door unless necessary
- Do not cover shelves with aluminium foil or any other shelf material which may prevent air circulation
- Should the wine cabinet be stored without use for long periods it is suggested, after careful cleaning, to leave the door ajar to allow air to circulate inside the cabinet in order to avoid possible formations of condensation, mould or odours.
- Keep ventilation openings, in the appliance enclosure or in the built-in structure, clear of obstruction;
- Do not use mechanical devices or other means to accelerate the defrosting process, other than those recommended by the manufacturer;
- Do not damage the refrigerant circuit;
- Do not use electrical appliances inside the storage compartments of the appliance, unless they are the type recommended by the manufacturer

OPERATING YOUR WINE CABINET

Please use the cabinet within ambient temperatures between 16-32°C, if the ambient temperature is higher or lower than this, it will cause the temperature to fluctuate in the cabinet, possibly preventing it from reaching 4-20°C.

SETTING THE TEMPERATURE

To change the temperature

- Press the "+" or "-" buttons until the required temperature is shown on the display.
- The preset temperature is 12°C.
- To change the temperature display from Fahrenheit to Celsius, or Celsius to Fahrenheit, Press and hold the "+" and "-" buttons for three seconds.
- Press and hold the "power" and "light" buttons for three seconds, the control panel can be switched to “locked” or “unlocked” mode. In the “locked” mode, none of button would react when being pressed.
- To view the set temperature, touch the "+" or "-" button at any time and the set temperature will flash in the LED display for five seconds.
- The display shows the set temperature when the wine cooler is on.

Optimal temperature selection

Whilst wine is best stored at temperatures between 13 and 15° C, your wine can also be stored at drinking temperature. For red wine this is between 15 and 17°C, and for white wine between 12 and 13°C.

NOTE

If the unit is unplugged, power lost or turned off, you must wait 3 to 5 minutes before restarting the unit. If you attempt to restart before this time delay, the wine cooler will not start.

When you use the wine cooler for the first time or you restart the cooler after having been shut off for a long time, there could be a few degrees variance between the temperature you select and the one indicated on the LED readout. This is normal and it is due to the length of the activation time. Once the wine cooler has been running for a few hours everything will be back to normal.

CONTROL PANEL

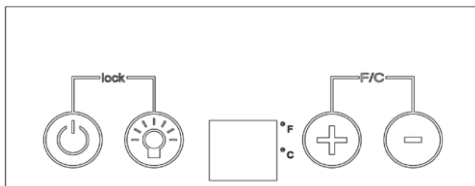

Buttons

Power -To switch the appliance on/off (press and hold this button for approximately 5 seconds)

Light -Used to switch the internal light on/off

“+” -Used to raise the temperature in 1°C increments

“-” -Used to lower the temperature in 1°C increments

TEMPERATURE ALARM

If inner temperature is higher than 25°C and after lasting more than 24 hours, “E3” is shown in the display panel, and the alarm sounds constantly. You can press any button to cease the alarm. When the inner temperature drops below 25°C, the alarm will go off automatically.

Internal light

Press the light button to switch the light on or off.

HOW TO CHANGE THE DOOR OPENING

This appliance has reversible doors but is delivered with a right hinged door. The left hand hinge kit comes with the unit (in the box), should you wish to reverse the hinge on your unit follow the directions below:

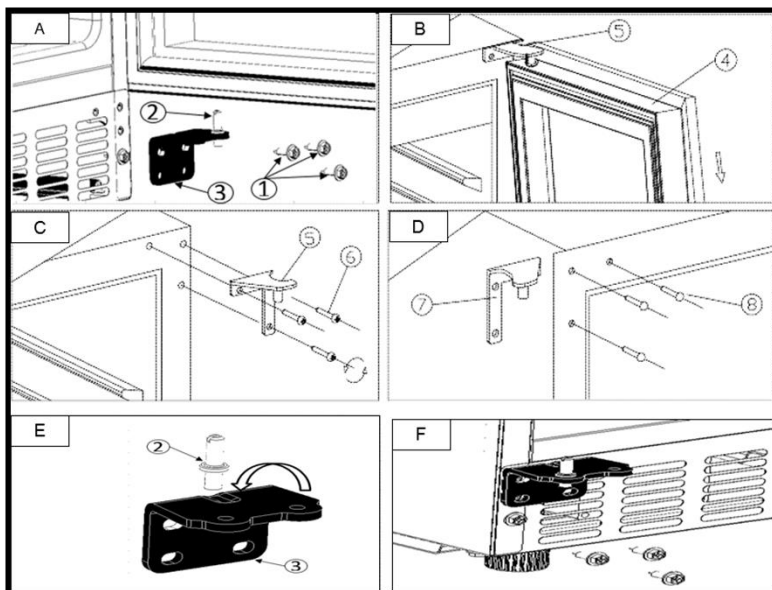

1 Screws 2 Hinge axis 3 Lower hinge 4 Door 5 Top hinge (Right) 6 Screws
7 Top hinge (Left) 8 decorative nail

1. Open the door to a 90 degrees angle, take out the 3 screws (1) from foamed cabinet, remove the door (4), Remove the Lower hinge (3) from the door, (A).
2. Take off the door (4) . (B)
3. Unscrew the 3 hinge screws (6) from the top hinge (right) (5) and remove it. (C)
4. Remove decorative caps (8) from left top of cabinet and install the spare top hinge (Left) (7) at left top of cabinet with 3 screws. (D)
5. Remove the hinge axis (2) from right to the left. (E)

-
6. Install and align the door.
 7. Move the screws (1) from left to the right side.
 8. Insert the plastic caps to cover the holes on the top right(8).

INSTALLING THE HANDLE

Remove the door gasket till you see the drilled holes by pulling from the top corner. (see below drawing). Fix the handle to the screws and push the gasket back into place.

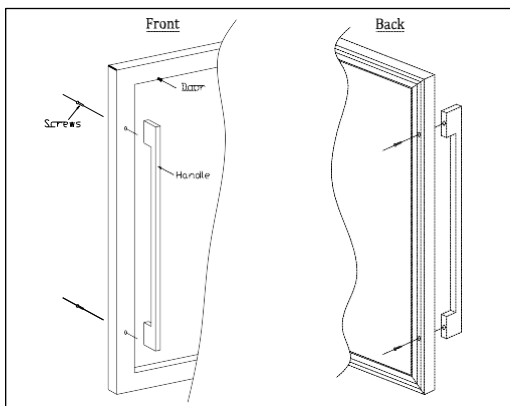

WINEBOTTLESTACKING

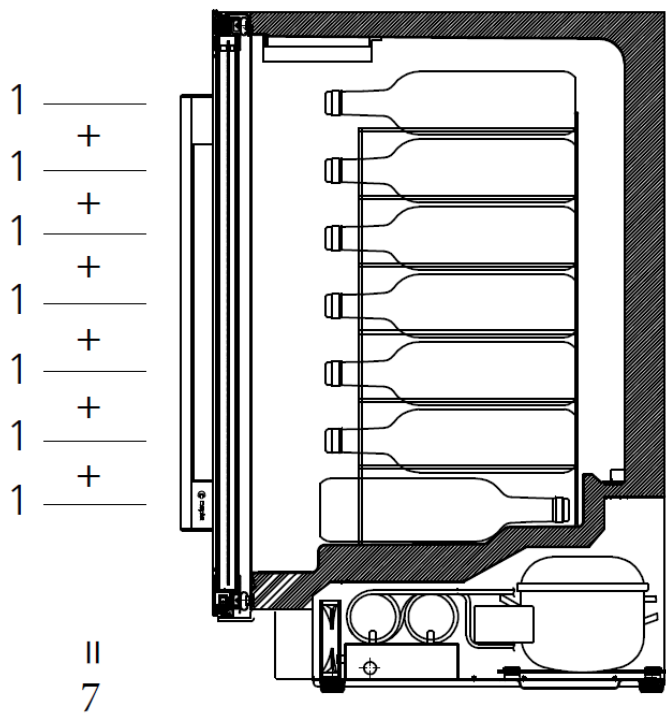

Stores max. 7 Bordeaux style bottles 750ml.

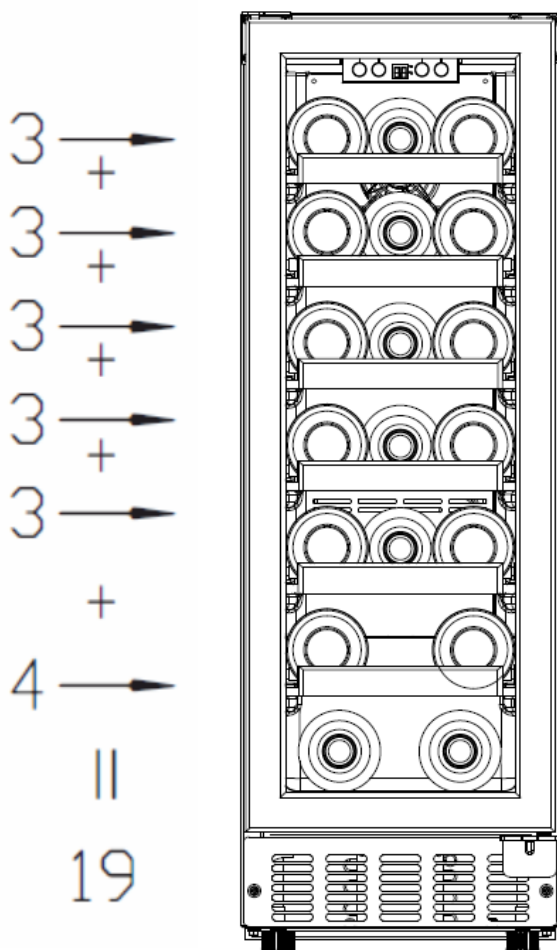

Stores max.19 Bordeaux style bottles 750ml.

CARE AND MAINTENANCE

Cleaning your wine cooler

- Turn off the power, unplug the appliance, and remove all items including shelves and rack.
- Wash the inside surfaces with a warm water and baking soda solution. The solution should be about 2 tablespoons of baking soda to 2 pints of water.
- Wash the shelves with a mild detergent solution.
- Wring excess water out of the sponge or cloth when cleaning the area of the controls, or any electrical parts.
- Wash the outside cabinet with warm water and mild liquid detergent. Rinse well and wipe dry with a clean soft cloth.

Note

Please take care when cleaning the plinth grille as this may contain sharp edges

Power failure

- Most power failures are corrected within a few hours and should not affect the temperature of your appliance if you minimise the number of times the door is opened. If the power is going to be off for a longer period of time, you need to take the proper steps to protect your contents.

Holidays

- Short holidays: Leave the wine cabinet operating during holidays of less than three weeks.
- Long holidays: If the appliance will not be used for several months, remove all items and turn off the appliance. Clean and dry the interior thoroughly. To prevent odour and mould growth, leave the door open slightly (blocking it open if necessary).

Moving your wine cooler

- Remove all items.
- Securely tape down all loose items (shelves) inside your appliance.
- Wind the adjustable legs up to the base to avoid damage.
- Tape the door shut.
- Be sure the appliance stays secure in the upright position during transportation. Also protect outside of appliance with a blanket, or similar item.

Energy saving tips

- The wine cabinet should be located in the coolest area of the room, away from heat producing appliances, and out of the direct sunlight.

PROBLEMS WITH YOUR WINE COOLER

You can solve many common wine cabinet problems easily, saving you the cost of a possible service call. Try the suggestions below to see if you can solve the problem before calling Primacare.

TROUBLESHOOTINGGUIDE

| Problem | PossibleCause |
|------------------------------------------------|---------------------------------------------------------------------------------------------------------------------------------------------------------------------------------------------------------------------------------------------------------------------------------------------------------------------------------------|
| The wine cabinet does not operate | Not plugged in. The appliance is turned off. The circuit breaker tripped or a blown fuse. |
| The wine cabinet is not cold enough | Check the temperature control setting. External environment may require a higher setting. The door is opened too often. The door is not closed completely. The door gasket does not seal properly. |
| The compressor turns on and off frequently | The room temperature is hotter than normal. A large amount of contents has been added to the wine cabinet. The door is opened too often. The door is not closed completely. The temperature control is not set correctly. The door gasket does not seal properly. |
| The light does not work | The circuit breaker tripped or a blown fuse. The bulb has burned out. The light button is “OFF”. |
| Vibrations | check that the appliance is level and installed on a flat, even surface |
| The wine cabinet seems to make too much noise. | The rattling noise may come from the flow of the refrigerant, which is normal. As each cycle ends, you may hear gurgling sounds caused by the flow of refrigerant in your wine cabinet. Contraction and expansion of the inside walls may cause popping and crackling noises, this is normal. The wine cabinet is not level. |
| The door will not close properly | The wine cabinet is not level. The door was reversed and not correctly installed. The gasket is dirty. The shelves are out of position. |

If the above table has not solved the problem please contact the service.

DEFROSTING/CONDENSATION

Your wine cabinet is designed with an “Auto-cycle” defrost system. When the RUN cycle is OFF, the refrigerated surface of the wine cabinet (interior rear wall) defrosts automatically. The defrosted water is channelled into a drain pan which is located at the back of the cabinet next to the compressor from where it evaporates.

Recommended storage temperatures

For storing ALL TYPES OF WINES 12°C to 14°C

Recommended drinking temperatures

| | |
|------------------------------------------------------------------------------------------------------------|------|
| Champagne NV, Sparkling | 6°C |
| Champagne Vintage | 10°C |
| Dry White Semillon, Sauvignon Blanc | 8°C |
| Dry White Gewürztraminer, Riesling | 10°C |
| Dry White Chardonnay | 10°C |
| Vintage Chardonnay 1 | 4°C |
| Sweet White Sauternes Monbazillac, Late Harvest ice wine | 10°C |
| Sweet whites vintage Sauternes | 14°C |
| Beaujolais | 13°C |
| Red Pinot Noir | 16°C |
| Vintage Pinot Noir red | 18°C |
| Red Cabernet, Merlot, French, Australian, New Zealand, Chilean, Argentinean, Italian, Spanish, Californian | 18°C |
| Red Grenache, Syrah | 16°C |

prima

Care

For more information on Prima appliances, please visit

www.prima-appliances.uk/primacare

For all your In-warranty service calls, phone 0844 576 6841

prima